

WESTGATE CRESCENT SLOUGH, SL1 5BX

Nestled in the charming area of Cippenham, this delightful semi-detached house on Westgate Crescent is now available for rent. This property boasts a welcoming reception room, perfect for relaxing or entertaining guests. With three well-proportioned bedrooms, it offers ample

£1,900 PCM



1



1



3

EPC D

space for families or professionals seeking a comfortable living environment.

The house features a modern bathroom, ensuring convenience for all residents. Additionally, there is parking available for one vehicle, making it easy for you to come and go as you please.

This property is ideally situated, providing easy access to local amenities and transport links, making it a perfect choice for those looking to enjoy the vibrant community of Cippenham. Available for immediate occupancy, this home is ready for you to move in and make it your own. Don't miss the opportunity to secure this lovely residence in a sought-after location.

- Available Now
- Offered Unfurnished
- 15 Minute Walk from Burnham Rail Station
- Within Walking Distance of Westgate School
- Excellent Transport Links
- Close to M4 Motorway (Junction 6)
- Near to Local Supermarket

Directions



GROUND FLOOR
595 sq.ft. (55.3 sq.m.) approx.

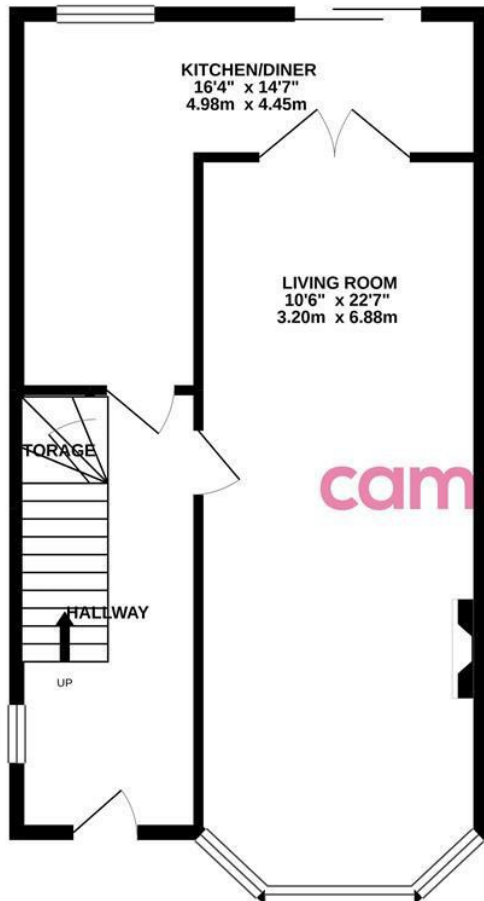

1ST FLOOR
399 sq.ft. (37.1 sq.m.) approx.

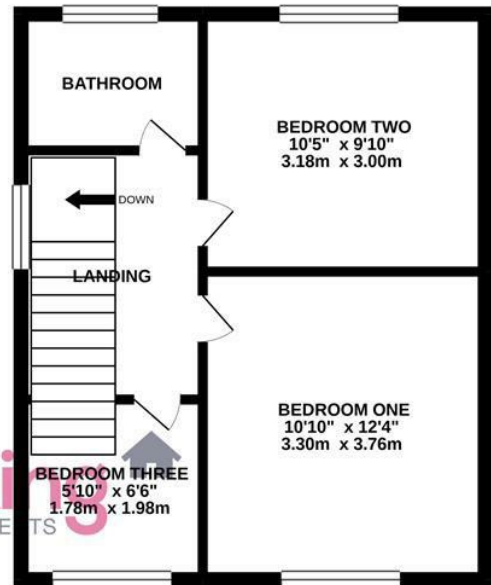

TOTAL FLOOR AREA : 994 sq.ft. (92.4 sq.m.) approx.

Whilst every attempt has been made to ensure the accuracy of the floorplan contained here, measurements of doors, windows, rooms and any other items are approximate and no responsibility is taken for any error, omission or mis-statement. This plan is for illustrative purposes only and should be used as such by any prospective purchaser. The services, systems and appliances shown have not been tested and no guarantee as to their operability or efficiency can be given.
Made with Metropix ©2021

cameron king
ESTATE AGENTS

411 Bath Road, Slough, SL1 5QL
t: 01628 667442
e: sales@cameronking.co.uk



rightmove

Zoopla

PrimeLocation.com